

GlasRoc™ Sheathing Type X Exterior Wall Fire-Rated Systems

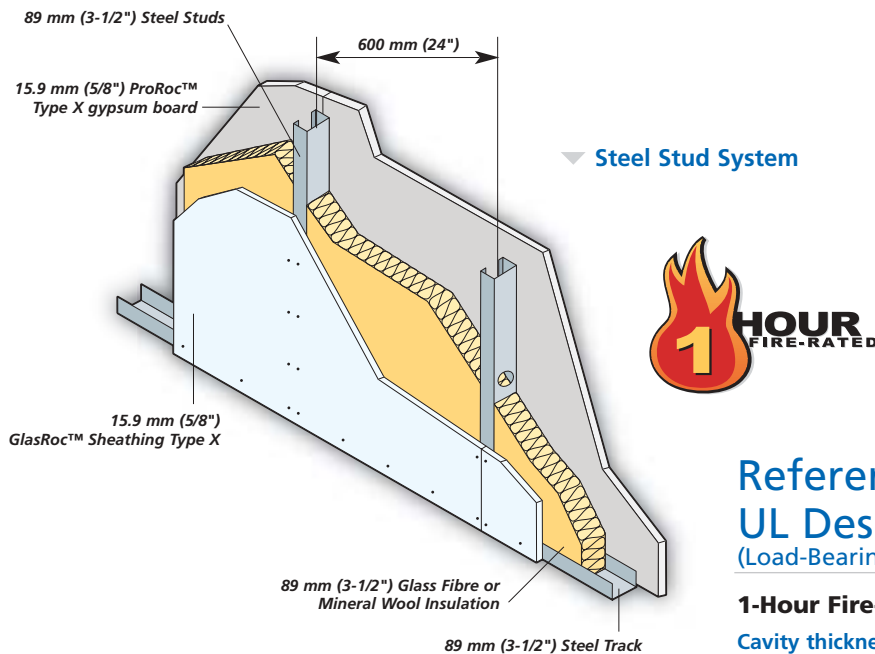

Reference:
UL Design U425
(Load-Bearing)

1-Hour Fire-Resistance Rating

Cavity thickness..... 89 mm (3-1/2")
Wall thickness..... 121 mm (4-3/4")
Weight..... 29 kg/m² (6 psf)

Interior

Install insulation between studs. Apply one layer of 15.9 mm (5/8") ProRoc™ Type X gypsum board vertically to interior side with 25 mm (1") Type S-12 steel screws spaced 300 mm (12") o.c. along edges and in the field. Joints must be offset from joints on the opposite side. Tape and finish joints.

Exterior

Apply one layer of 15.9 mm (5/8") GlasRoc™ Sheathing Type X vertically to exterior side with 25 mm (1") screws spaced 300 mm (12") o.c. along edges and in the field. Joints must be offset from joints on the opposite side.