

GlasRoc™ Sheathing Type X Exterior Wall Fire-Rated Systems

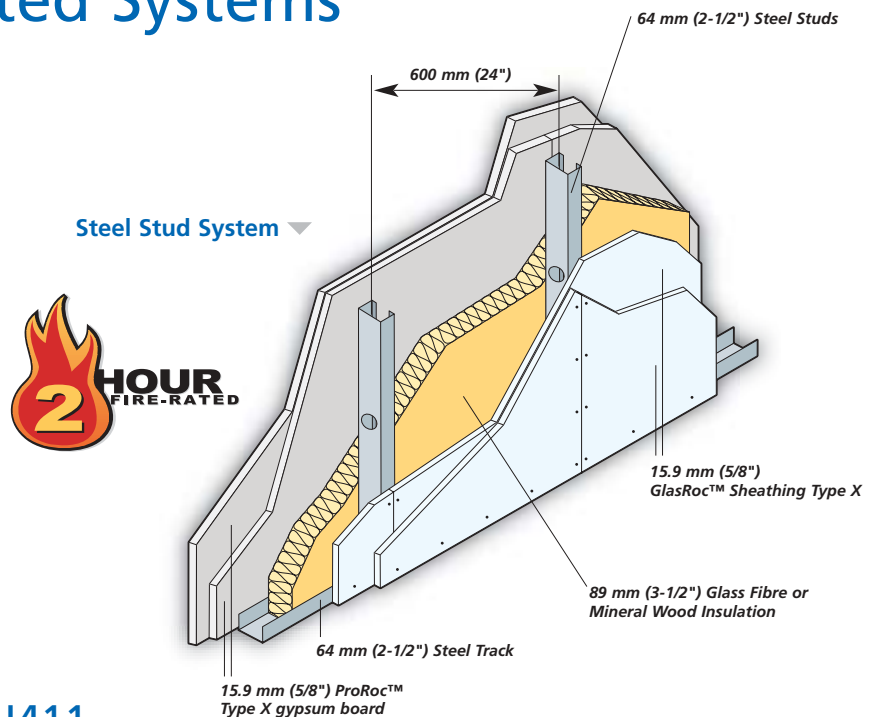

Reference: UL Design U411

2-Hour Fire-Resistance Rating

Cavity thickness..... 64 mm (2-1/2")

Wall thickness..... 127 mm (5")

Weight..... 54 kg/m² (11 psf)

Interior

Install insulation between studs. Apply a base layer of 15.9 mm (5/8") ProRoc™ Type X gypsum board vertically to interior side with 25 mm (1") Type S steel screws spaced 400 mm (16") o.c. along edges and in the field. Joints must be offset from joints on the opposite side.

Apply a face layer of 15.9 mm (5/8") ProRoc™ Type X gypsum board vertically over base layer with 41 mm (1-5/8") Type S steel screws. Space fasteners 400 mm (16") o.c. along edges and 300 mm (12") o.c. along floor and ceiling runners. Joints must be offset from joints in the underlying layer. Tape and finish joints.

Exterior

Apply a base layer of 15.9 mm (5/8") GlasRoc™ Sheathing Type X vertically to exterior side with 25 mm (1") Type S steel screws spaced 400 mm (16") o.c. along edges and in the field. Joints must be offset from joints on the opposite side.

Apply a face layer of 15.9 mm (5/8") GlasRoc™ Sheathing Type X vertically over base layer with 41 mm (1-5/8") Type S steel screws. Space fasteners 400 mm (16") o.c. along edges and field and 300 mm (12") o.c. along the floor and ceiling runners. Joints must be offset from joints in the underlying layer.