

GlasRoc™ Sheathing Type X Exterior Wall Fire-Rated Systems

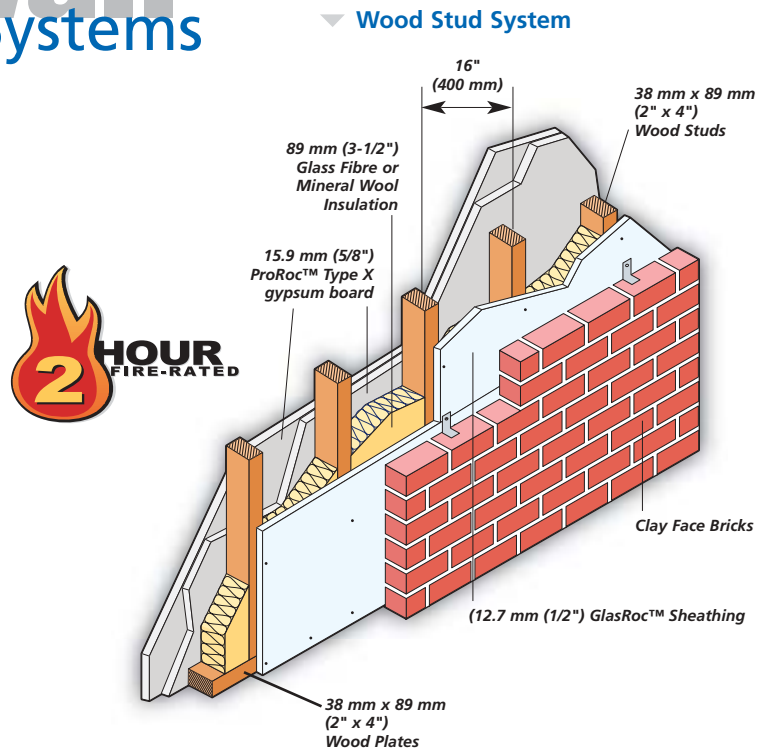

Reference: UL Design U302

2-Hour Fire-Resistance Rating

Cavity thickness..... 89 mm (3-1/2")

Wall thickness..... 254 mm (10")

Interior

Install insulation between studs.

Apply a base layer of 15.9 mm (5/8")

ProRoc™ Type X gypsum board vertically or horizontally with 48 mm (1-7/8") nails spaced 200 mm (8") o.c. Vertical joints must be located over framing members.

Apply a face layer of 15.9 mm (5/8") ProRoc™ Type X gypsum board vertically or horizontally to the interior side with 60 mm (2-3/8") nails spaced 200 mm (8") o.c. Joints must be offset from joints in the underlying layer. Tape and finish joints.

Exterior

Apply one layer of 12.7 mm (1/2") GlasRoc™ Sheathing horizontally to the exterior side with 44 mm (1-3/4") roofing nails spaced 150 mm (6") o.c. Vertical joints must be located over framing members and staggered.

Additional UL Design Listings for Wood Stud Systems:

U322, U323, U324, U325, U326, U329, U330, U332, U337, U338, U339, U341, U342, U354, U355, U357, U358, U360.