

# GlasRoc™ Sheathing Exterior Wall Systems

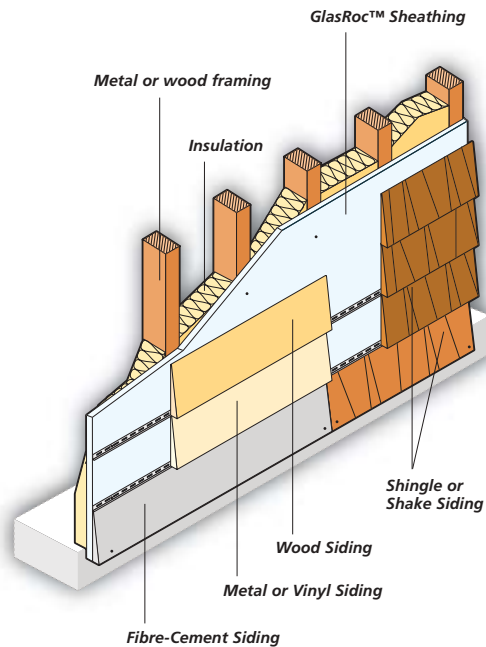

07480/09253

## Exterior Cladding

There are numerous exterior claddings available today, from shingles to shakes to a multitude of siding alternatives.

**GlasRoc™** Sheathing is an excellent choice for any of these applications. Simply install **GlasRoc™** Sheathing and apply the preferred exterior cladding, per the manufacturer's recommendations. Depending on local building codes, a joint treatment, building felt, or building wrap may be necessary.

### Referenced Standards

- ASTM C 514: Specification for Nails for the Application of Gypsum Board
- ASTM C 954: Specification for Steel Drill Screws for the Application of Gypsum Panel Products or Metal Plaster Bases to Steel Studs from 0.33 in. (0.84 mm) to 0.112 in. (2.84 mm) in Thickness
- ASTM C 1002: Standard Specification for Steel Drill Screws for the Application of Gypsum Panel Products or Metal Plaster Bases
- ASTM C 1177: Standard Specification for Glass Mat Gypsum Substrate for Use as Sheathing
- ASTM C 1280: Standard Specification for Application of Gypsum Sheathing
- CAN/ULC-S102 / ASTM E 84: Test Method for Surface Burning Characteristics of Building Materials
- ASTM E 96: Test Methods for Water Vapour Transmission of Materials
- CAN/ULC-S101 / ASTM E 119: Test Method for Fire Tests of Building Construction and Materials